



ESECUZIONI STANDARD

- **LPR**: levetta in acciaio zincato.
- **LPR-SST**: levetta in acciaio INOX AISI 304.

MATERIALE

Acciaio zincato.

- 1
- 2
- 3
- 4
- 5
- 6
- 7
- 8
- 9
- 10
- 11
- 12
- 13
- 14
- 15
- 16
- 17
- 18



Montaggio su maniglia PR-CH

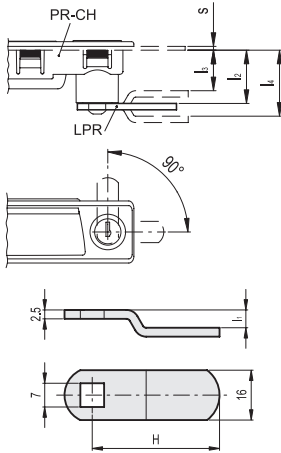

Montaggio su maniglia GN 115.10

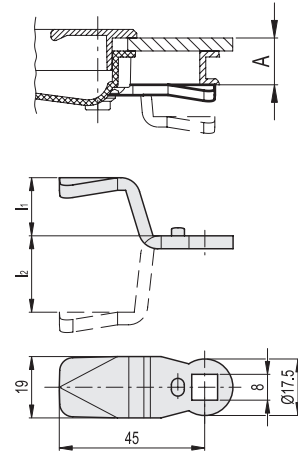

LPR

Codice	Descrizione	H	l1	s+l2	s+l3	s+l4	⚖️
421041	LPR-0-17	17.5	0	23.2	-	-	7
421045	LPR-0-22	22	0	23.2	-	-	8
421049	LPR-0-32	32	0	23.2	-	-	11
421053	LPR-0-46	46	0	23.2	-	-	15
421057	LPR-2-24	24.5	2	-	21.2	25.2	8
421061	LPR-2-28	27.8	2	-	21.2	25.2	10
421065	LPR-2-34	34.5	2	-	21.2	25.2	11
421069	LPR-5-30	30	5	-	18.2	28.2	10
421073	LPR-5-33	33	5	-	18.2	28.2	11
421077	LPR-5-35	35.5	5	-	18.2	28.2	12
421081	LPR-8-32	32.5	8	-	15.2	31.2	13
421085	LPR-12-26	26.5	12	-	11.2	35.2	12

Codice	Descrizione	l1	l2	A	⚖️
GN.39101	GN 115-2.1-4	14	-	4	30
GN.39103	GN 115-2.1-6	12	-	6	28
GN.39105	GN 115-2.1-8	10	-	8	26
GN.39107	GN 115-2.1-10	8	-	10	24
GN.39109	GN 115-2.1-13	5	-	13	21
GN.39111	GN 115-2.1-14	4	-	14	20
GN.39113	GN 115-2.1-16	2	-	16	18
GN.39115	GN 115-2.1-18	0	0	18	16
GN.39117	GN 115-2.1-20	-	2	20	18
GN.39119	GN 115-2.1-22	-	4	22	20
GN.39121	GN 115-2.1-24	-	6	24	22
GN.39123	GN 115-2.1-26	-	8	26	24
GN.39125	GN 115-2.1-28	-	10	28	26
GN.39127	GN 115-2.1-30	-	12	30	28
GN.39129	GN 115-2.1-32	-	14	32	30
GN.39131	GN 115-2.1-34	-	16	34	32
GN.39133	GN 115-2.1-36	-	18	36	34
GN.39135	GN 115-2.1-38	-	20	38	36
GN.39137	GN 115-2.1-40	-	22	40	38
GN.39139	GN 115-2.1-42	-	24	42	40
GN.39141	GN 115-2.1-45	-	27	45	43
GN.39143	GN 115-2.1-50	-	32	50	48

LPR-SST



Codice	Descrizione	H	l1	s+l2	s+l3	s+l4	⚖️
421046	LPR-0-20-SST	19.8	0	23.2	-	-	8
421050	LPR-0-32-SST	32	0	23.2	-	-	11
421054	LPR-0-46-SST	46	0	23.2	-	-	15
421068	LPR-0-45-SST	45	3	-	20.2	26.2	15

Chiusure